



Website: www.cndentals.com
Email: info@cndentals.com



Professional Dental Education Solutions





Dental Practice Teaching Assessment System

Powered by cutting-edge, user-friendly digital technologies, it **captures 3D data of dental preparations in real time at the chairside**, and automatically compares and analyzes it against standard models. A **comprehensive assessment** is conducted covering preparation volume, morphology, undercut, convergence degree, as well as adjacent tooth/gingival damage. Targeted cause analysis and optimization suggestions are intelligently generated for identified issues, effectively facilitating students' self-directed learning.



- Obtain 3D data of operations at any time beside the chair, automatically analyze the operation results, and realize self-evaluation.
- Practice teaching is closely integrated with clinical application, achieving seamless connection between classroom and clinic, and shortening the internship time.
- Explore a new interactive teaching mode that shifts from "teaching-oriented" to "learning-oriented", realize the transformation of students from "learning to know" to "learning to learn", fully mobilize students' enthusiasm and initiative in learning, and thus improve teaching efficiency.



Operation - Full-process Guidance

- Display operation requirements, skills, precautions and excellent experiences in various forms, which is conducive for students to quickly master theories and skills.

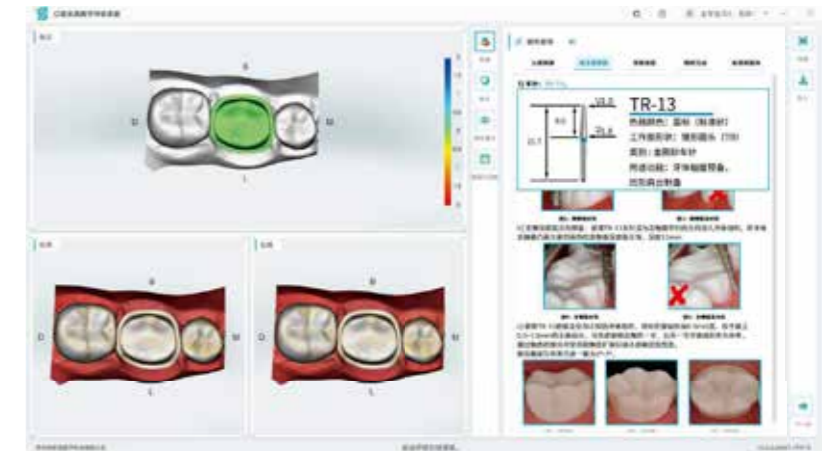

Results - Comprehensive Analysis

- Refine assessment items, highlight error locations, and reduce the time for problem diagnosis.
- Conduct in-depth cause analysis to help students focus on problems and countermeasures, and reduce the burden of teachers' answering questions.

Configuration

Name	No.	Qty
Dental Practical Teaching Evaluation System Software	V1.0	1 SET
3D Data Acquisition System	P5	1 SET
Workstation	Customized	1 SET
Imaging Terminal	24 inch	1 SET
Keyboard and Mouse Set	Wireless	1 SET
Equipment Cart	Customized	1 SET
Upper & Lower Teeth Model	28 Teeth	1 SET
Instruction Manual	/	1 SET
Certificate of Conformity	/	1 SET

Standard Structure

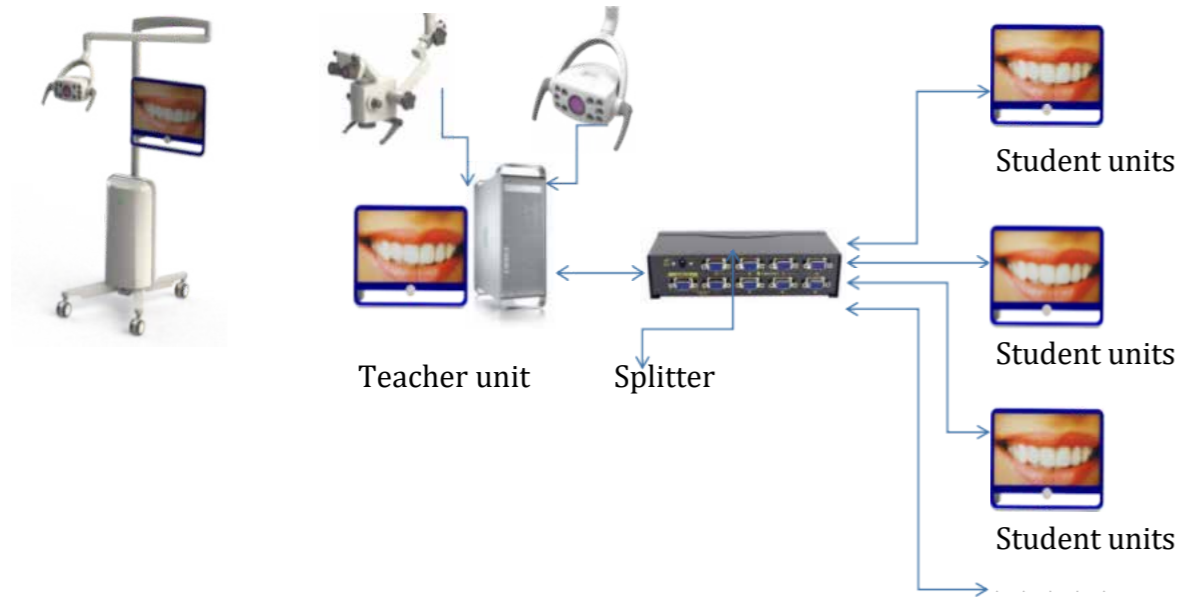

Two-way Interaction

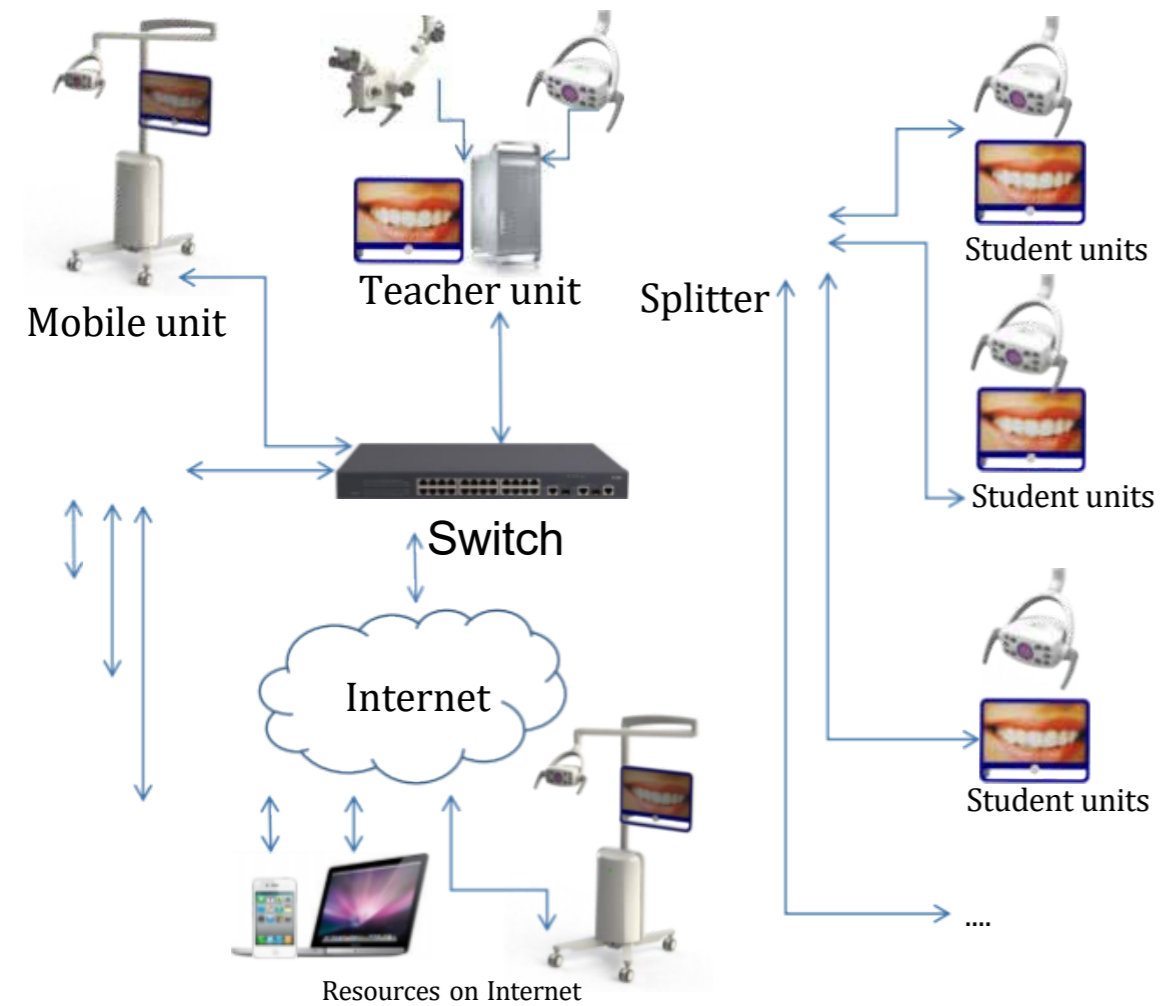

DV Series Demonstration System



▪ Optic zoom	20X	▪ CRI	>85
▪ Digital zoom	X12	▪ LCD	LCD128x64
▪ Focus	Auto/Manual	▪ Video card	HDMI/YUV
▪ Work distance	400~600mm	▪ Control	RS485/ RJ45
▪ Resolution	1920x1080	▪ Voltage	DC12V
▪ Output	HDMI/YUV/SDI	▪ Power	<15W
▪ CCD/CMOS	1/3'SONY	▪ Monitor	LCD22' IPS
▪ Main light	35000lx	▪ Resolution	1920x1080
▪ kailwen	4500~6000k	▪ Power	<35W
▪ Slave light	IR/UV/RED		

- Digital video record
- Max 40X optic zoom
- IR image view
- 3rd axis
- Could be mounted on dental unit or ceiling and wall
- Show that the process of teaching
- Real time to recording video image and playing



Mobile Type



Machine Type



Wall Hanging Mode





ES200



No.	Subject	Parameter	Momentum	Remark
1	Power	AC 220V	±10%	
2	Input power	Max 200W		Including addition equipment
3	Input pressure	0.8MPa		Internal pressure 0.55 MPa
4	Gas consumption	55 L/Min	± 10 L/Min	
5	Height of workbench	800mm		
6	Phantom pitch	0 °~+90 °	±5 °	Hand-Control Unit
7	Noise	≤43 dB		
8	Operating Light	≥20000 lx		
9	stool moving distance	L 440mm	140±5mm	
10	Dimension	1500×600×800		
11	G.W.	125kg		



ES260



No.	Subject	Parameter	Momentum	Remark
1	Power	AC 220V	±10%	
2	Input power	Max 200W		Including addition equipment
3	Input pressure	0.8 MPa		Internal pressure 0.55 MPa
4	Gas consumption	55 L/Min	± 10 L/Min	
5	Height of workbench	800 mm		
6	Phantom pitch	0 °~+90 °	±5 °	Prone Air-Operated Control Unit
7	Noise	≤43 dB		
8	Operating Light	≥20000lx		
9	stool moving distance	L 440 mm	140±5 mm	
10	Dimension	1500×600×800mm		
11	G.W.	125 kg		



ES320



No.	Subject	Parameter	Momentum	Remark
1	Power	AC 220V	±10%	
2	Input power	Max 200W		Including addition equipment
3	Input pressure	0.8 MPa		Internal pressure 0.55 MPa
4	Gas consumption	55 L/Min	± 10 L/Min	
5	Height of workbench	800mm		
6	Phantom pitch	0 °~+90 °	±5 °	Pneumatic Mobile Unit
7	Noise	≤43 dB		
8	Operating Light	≥20000 lx		
9	stool moving distance	L 440mm	140±5mm	
10	Dimension	1500×600×800		
11	G.W.	125kg		



ES800



No.	Subject	Parameter	Momentum	Remark
1	Power	AC 220V	±10%	
2	Input power	Max 200W		Including addition equipment
3	Input pressure	0.8 MPa		Internal pressure 0.55 MPa
4	Gas consumption	55 L/Min	± 10 L/Min	
5	Height of workbench	800mm		
6	Phantom pitch	-5 °~+90 °	±5 °	Panel control with memory program
7	Phantom Moving	Lowest 400-600mm	Raising 200±5mm	Panel control with memory program
8	Noise	≤43 dB		
9	Operating Light	≥20000 lx		
10	stool moving distance	L 440mm	140±5mm	
11	Dimension	1000×1000×1100mm		
12	G.W.	145kg		



ES600



ES680



No.	Subject	Parameter	Momentum	Remark
1	Power	AC 220V	±10%	
2	Input power	Max 200W		Including addition equipment
3	Input pressure	0.8 MPa		Internal pressure 0.55 MPa
4	Gas consumption	55 L/Min	± 10 L/Min	
5	Height of workbench	800mm		
6	Phantom pitch	-5 °~+75°	±5 °	Panel control with memory program
7	Phantom Moving	Lowest 400-600mm	Raising 250±5mm	Panel control with memory program
8	Noise	≤43 dB		
9	Operating Light	≥20000 lx		
10	stool moving distance	L 440mm	140±5mm	
11	Dimension	1200x600x950mm		
12	G.W.	145kg		

No.	Subject	Parameter	Momentum	Remark
1	Power	AC 220V	±10%	
2	Input power	Max 200W		Including addition equipment
3	Input pressure	0.8 MPa		Internal pressure 0.55 MPa
4	Gas consumption	55 L/Min	± 10 L/Min	
5	Height of workbench	800mm		
6	Phantom pitch	-5 °~+90 °	±5 °	Panel control with memory program
7	Phantom Moving	Lowest 400-600mm	Raising 300±5mm	Panel control with memory program
8	Noise	≤43 dB		
9	Operating Light	≥20000 lx		
10	stool moving distance	L 440mm	140±5mm	
11	Dimension	1200x600x950mm		
12	G.W.	145kg		



Dental Training Manikin



EM7009



EM7006



EM7004

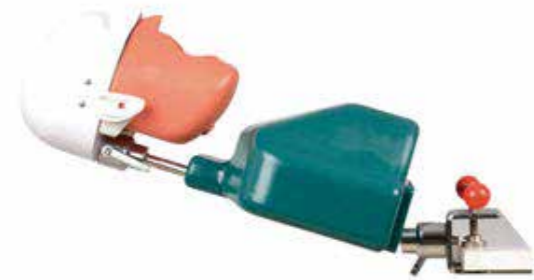

EM7007



EM7003



EM7008



EM7001

Dental Phantom Head

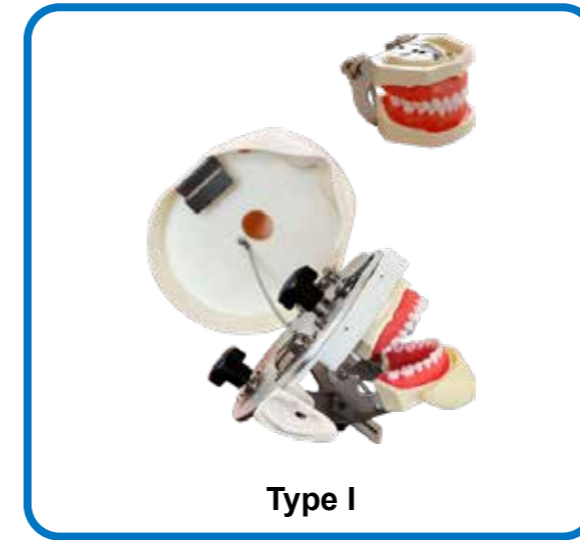

Type I

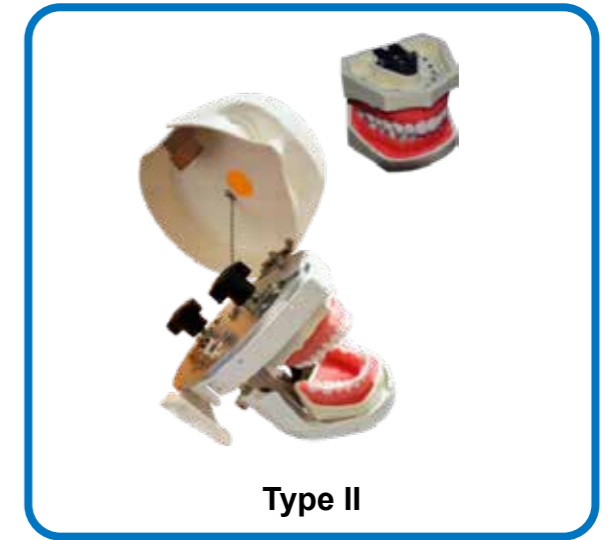

Type II

Teeth Model



EM1001

Standard Model (28/32 pcs, hard gum, wax fixed)



EM1002

Standard Model (28/32 pcs, hard gum, screw fixed)



EM1003

Standard Model (28/32 pcs, soft gum, screw fixed)

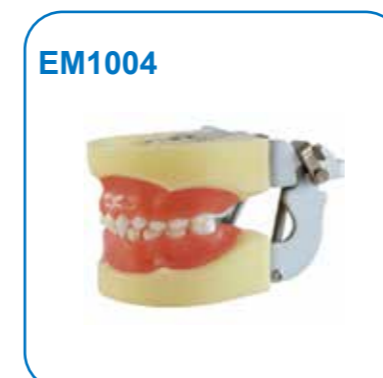

EM1004

Standard Child Model (24/28 pcs, soft gum, screw fixed)



EM1005

Standard Model (28/32 pcs, hard gum, wax fixed)



EM1006

Standard Model (28/32 pcs, soft gum, screw fixed)

Dental Practice Model

Dental Demo Model



EM1007
Standard Model
(28/32 pcs, soft gum,
transparent)



EM1008
Removable Standard
Model (28/32 pcs,
hard gum)



EM1009
Removable Standard
Model (28/32 pcs,
hard gum, transparent)



EM1010
Removable Standard
Model (28/32 pcs, soft
gum, transparent)



EM2001
Orthodontic Model



EM2002
Orthodontic Metal
Model



EM2003
Orthodontic Metal &
Ceramic Model



EM2004
Orthodontic Ceramic
Model



EM1011
Face/mouth Opener
for Tooth Preparation

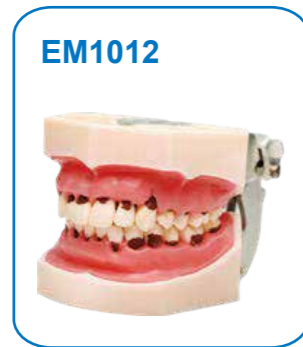

EM1012
Dental Stone Removal
Training Model

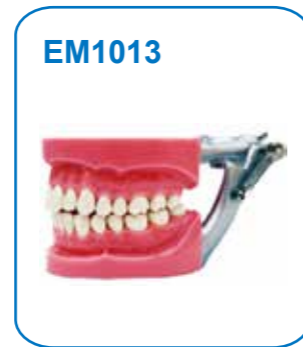

EM1013
Standard Model
(28/32 pcs, hard gum,
screw fixed)



EM1014
Standard Model
(28/32 pcs, soft gum,
screw fixed)

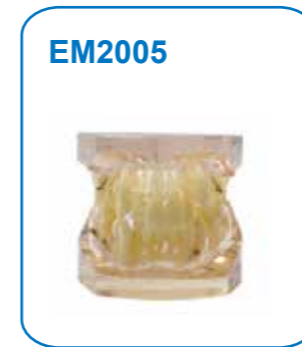

EM2005
Orthodontic Model

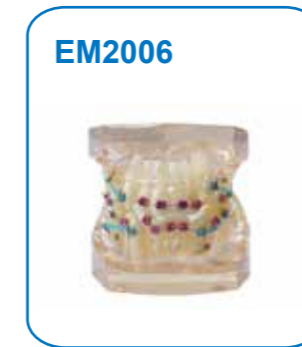

EM2006
Orthodontic Metal
Model

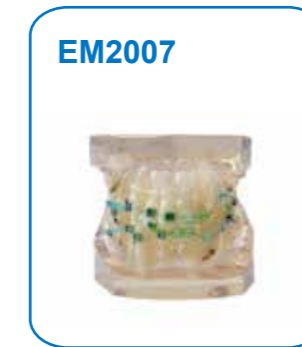

EM2007
Orthodontic Metal &
Ceramic Model



EM2008
Orthodontic Ceramic
Model



EM1015
Standard Model
(28/32 pcs, soft gum,
screw)

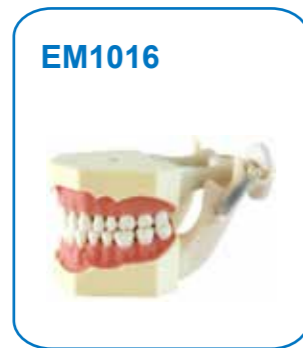

EM1016
Standard Model
(28/32 pcs, soft gum)



EM1017
Standard Model
(28/32 pcs, hard gum)



EM1018
Removable Standard
Model (28/32 pcs, soft
gum, transparent)



EM2009
Orthodontic Model



EM2010
Orthodontic Metal
Model



EM2011
Orthodontic Metal &
Ceramic Model



EM2012
Orthodontic Ceramic
Model



Dental Demo Model

Dental Demo Model



EM2013

Orthodontic Model



EM2014

Orthodontic Metal Model



EM2015

Orthodontic Metal & Ceramic Model



EM2016

Orthodontic Ceramic Model



EM2017

Orthodontic Model



EM2018

Orthodontic Metal Model



EM2019

Orthodontic Metal & Ceramic Model



EM2020

Orthodontic Ceramic Model



EM2021

1/2 Standard Model



EM2022

Orthodontic Metal Model



EM2023

Ortho with Edgewise Bracket



EM2024

Typodont Practice Model



EM3001

Pathology Model with Half Implant

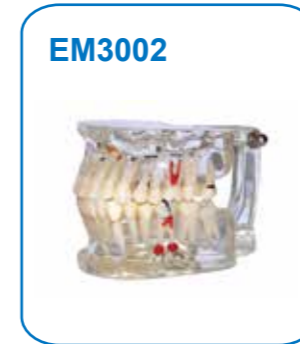

EM3002

Pathology Model with missing a tooth



EM3003

Half side can be removable Model



EM3004

Pathology Model with Implant



EM3005

Clear Mixed Age Model



EM3006

Clear Mixed Age with Pathology



EM3007

Clear Mixed Age Model with Caries



EM3008

Clear Mixed with Missing Teeth Model



EM3009

Clear Extraction Model



EM3010

Clear Primary Teeth Model



EM3011

Half Pathology Model



EM3012

Clear Mixed Age with Caries